



KONICA MINOLTA

**bizhub** 4750i

Black & White A4 multifunctional printer

**bizhub  
i-SERIES IS  
SMARTER  
WORKING**  
RETHINK IT



Giving Shape to Ideas

## CUSTOMER BENEFITS



### Intuitive operability

Operate the bizhub like a smartphone or tablet with fully customized user interface



### Mobile connectivity

Print anytime from anywhere with Konica Minolta's innovative mobile technologies



### Security

Secure network integration, data encryption, and advanced user authentication



### Application ecosystem

Enhanced efficiency thanks to Konica Minolta's extensive applications portfolio



### Services

Efficient printer fleet management, including automatic consumables delivery, pro-active maintenance and remote setup



### Sustainability

Numerous eco features reduce energy consumption and costs

## OPTIONS

### 1 ENHANCED FEATURES

#### Voice Guidance

LK-104v3

#### OCR text recognition

LK-105v4

#### Barcode fonts

LK-106

#### Unicode fonts

LK-107

#### OCR A and B fonts

LK-108

#### Document converter pack

LK-110v2

#### ThinPrint® client

LK-111

#### Antivirus

LK-116

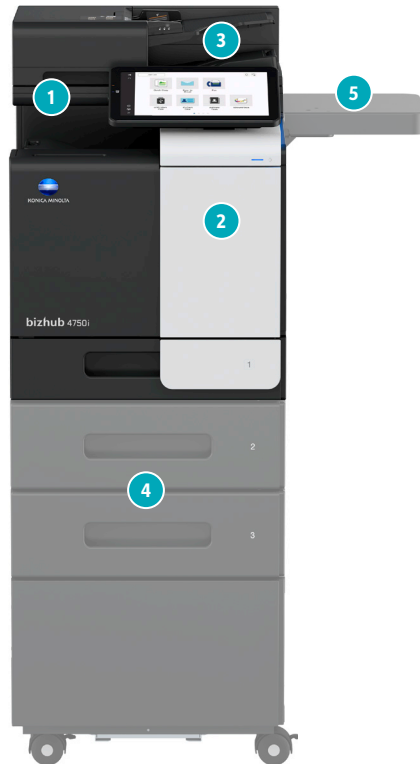

### 2 CONNECTIVITY

#### Fax board (Standard)

FK-517

#### Wireless LAN (Standard)

UK-221

#### NFC (Standard)

EK-P10

#### USB I/F kit

EK-P08

#### USB I/F kit

EK-P09

#### Biometric authentication

AU-102

#### ID card reader

#### Mount kit

MK-P08

### LEGEND

Mandatory option

Option

This option can only be installed with the respective option above it

### 3 MISCELLANEOUS

#### Working table

WT-P03

#### Expanded Memory SSD

EM-908

#### Double feed detection kit

UK-P19

#### 10-Key pad

KP-102

#### Keyboard holder

KH-P02

### 4 MEDIA INPUT

#### Paper tray

PF-P21

#### Height adjustment unit

PF-P25

#### Copier desk

DK-P05

### 5 MEDIA OUTPUT

#### Off-line stapler

FS-P04

## FINISHING FUNCTIONALITIES



Duplex



Corner  
Stapling  
(offline)

## DESCRIPTION

### ENHANCED FEATURES

LK-104v3	Voice Guidance
LK-105v4 OCR text recognition	Searchable PDF and PPTX
LK-106 Barcode fonts	Supports native barcode printing
LK-107 Unicode fonts	Supports native Unicode printing
LK-108 OCR A and B fonts	Supports native OCR A and B font printing
LK-110v2 Document converter pack	Generates various file formats incl. DOCX, XLSX and PDF/A
LK-111 ThinPrint® client	Print data compression for reduced network impact
LK-116 Antivirus	Bitdefender® antivirus provides real time scanning of all incoming and outgoing data

### CONNECTIVITY

FK-517 Fax board (standard)	Super G3 fax, digital fax functionality
UK-221 Wireless LAN (standard)	Wireless LAN and wireless LAN Access Point Mode
EK-P10 NFC (Standard)	NFC (Near Field Communication) Support
EK-P08 USB I/F kit	USB keyboard connection
EK-P09 USB I/F kit	USB keyboard connection; Bluetooth
AU-102 Biometric authentication	Finger vein scanner
ID card reader Card authentication	Various ID card technologies
MK-P08 Mount kit	Installation kit for ID card reader

### OTHERS

WT-P03 Working table	Authentication device placement
EM-908 Expanded Memory SSD	1 TB SSD to increase storage space
UK-P19 Double feed detection kit	Multi-feed detector to reduce errors and paper jams
KP-102 10-Key pad	For use instead of touchscreen
KH-P02 Keyboard holder	To place USB keyboard

### MEDIA INPUT

PF-P21 Paper tray	500 sheets, A4, 60-90 g/m <sup>2</sup>
PF-P25 Height adjustment unit	To achieve comfortable height for operation
DK-P05 Copier desk	Provides storage space for print media and other materials

### MEDIA OUTPUT

FS-P04 Off-line stapler	20-sheet off-line stapling
-------------------------	----------------------------

## TECHNICAL SPECIFICATIONS

### SYSTEM SPECIFICATIONS

System speed letter	Up to 50 ppm
Autoduplex speed letter	Up to 50 ppm
1st page out time letter	4.3 sec.
Warm-up time <sup>1</sup>	Approx. 13 sec.
Imaging technology	Laser
Toner technology	Simitri® HD polymerized toner
Panel size/resolution	10.1" / 1024 x 600
System memory	5 GB (standard/max)
Solid state drive	256 GB SSD (standard) / 1 TB SSD (optional)
Interface	10/100/1,000-Base-T Ethernet; USB 2.0; USB 3.0; Wi-Fi 802.11 b/g/n/ac (optional)
Network protocols	TCP/IP (IPv4 / IPv6); SMB; LPD; IPP; SNMP; HTTP(S); Bonjour
Automatic document feeder	Up to 80 originals; 8.5" x 14"L to 5.5" x 8.5"; 50-128 g/m <sup>2</sup> ; Dualscan ADF
ADF double feed detection	Optional
Printable paper size	3.5" x 8.8" to 8.5" x 14"
Printable paper weight	60-210 g/m <sup>2</sup>
Paper input capacity	600 sheets / 1,600 sheets (standard/max)
Paper tray input (standard)	1x 500; 3.9" x 5.8" to 8.5" x 11"; 60-210 g/m <sup>2</sup>
Paper tray input (optional)	1x 500 sheets; letter; 60-90 g/m <sup>2</sup> (up to 2x)
Manual bypass	100 sheets; 3.5" x 8.8" to 8.5" x 14"; 60-210 g/m <sup>2</sup>
Finishing modes (optional)	Offset; Group; Sort; Staple (offline)
Automatic duplexing	4.7" x 8.8" to 8.5" x 14"; 60-210 g/m <sup>2</sup>
Output capacity	Up to 250 sheets
Duty cycle (monthly) <sup>2</sup>	Max. 120,000 pages
Toner lifetime	Up to 20,000 pages (black)
Imaging unit lifetime	Up to 200,000 pages (imaging unit) (black)
Power consumption	110-120V, 60Hz; Less than 1.45 kW
System dimension (W x D x H)	16.5" x 20.8" x 22.5" (without options)
System weight	Approx. 77 lbs (without options)

### PRINTER SPECIFICATIONS

Print resolution	1200 x 1200 dpi
Page description language	PCL 6 (XL3.0); PCL 5c; PostScript 3 (CPSI 3016); XPS
Operating systems	Windows 7 (32/64); Windows 8.1 (32/64); Windows 10 (32/64); Windows Server 2008 (32/64); Windows Server 2008 R2; Windows Server 2012; Windows Server 2012 R2; Windows Server 2016; Windows Server 2019; Macintosh OS X 10.10 or later; Unix; Linux; Citrix
Printer fonts	80 PCL Latin; 137 PostScript 3 Emulation Latin
Mobile printing	AirPrint (iOS); Mopria (Android); Konica Minolta Print Service (Android); Konica Minolta Mobile Print (iOS/Android) WiFi Direct; Mobile Authentication and Pairing (iOS/Android)

### SCANNER SPECIFICATIONS

Scan speed	48 opm in simplex (mono/color) 96 opm in duplex (mono/color)
Scan resolution	Up to 600 x 600 dpi
Scan modes	Scan-to-eMail (Scan-to-Me); Scan-to-SMB (Scan-to-Home); Scan-to-FTP; Scan-to-Box; Scan-to-USB; Scan-to-WebDAV; Scan-to-DPWS; Scan-to-URL; TWAIN scan
File formats	JPEG; TIFF; PDF; Compact PDF; Encrypted PDF; XPS; Compact XPS; PPTX optional: Searchable PDF; PDF/A 1a and 1b; Searchable DOCX/PPTX/XLSX

## SCANNER SPECIFICATIONS

Scan destinations	2,000 destinations + 100 groups; LDAP support
-------------------	---

## COPIER SPECIFICATIONS

Copy resolution	600 x 600 dpi
Gradation	256 gradations
Multicopy	1-9,999
Original format	3.5" x 8.8" to 8.5" x 14"
Magnification	25-400% in 0.1% steps; Auto-zooming

## FAX SPECIFICATION

Fax standard	Super G3
Fax transmission	Analog; i-Fax; Color i-Fax; IP-Fax
Fax resolution	Up to 600 x 600 dpi
Fax compression	MH; MR; MMR; JBIG
Fax modem	Up to 33.6 Kbps
Fax destinations	2,000 single + 100 groups

## USER BOX SPECIFICATIONS

Storable documents	Up to 3,000 documents or 10,000 pages
Type of user boxes	Public; Personal (with password or authentication); Group (with authentication)
Type of system boxes	Secure print; Encrypted PDF print; Fax reception; Fax polling

## SYSTEM FEATURES

Security	ISO 15408 HCD-PP Common Criteria (in evaluation); IP filtering and port blocking; SSL3 and TLS1.0/1.1/1.2 network communication; IPsec support; IEEE 802.1x support; User authentication; Authentication log; Secure print; Kerberos; Hard drive overwrite; SSD data encryption (AES 256); Confiden- tial fax; Print user data encryption optional: Antivirus realtime scanning (Bitdefender®)
Accounting	Up to 1,000 user accounts; Active Directory support (user name + password + e-mail + smb folder); User function access definition; Authentication by mobile device (Android) optional: Biometric authentication (finger vein scanner); ID card authentication (ID card reader); Authentication by mobile device (iOS)
Software	Net Care Device Manager; Data Administrator; Box Operator; Web Connection; Print Status Notifier; Driver Packaging Utility; Log Management Utility

<sup>1</sup> Warm-up time may vary depending on the operating environment and usage

<sup>2</sup> If the maximum volume is reached within a period of one year, then a maintenance cycle must be performed

- All specifications refer to A4-size paper of 80 g/m<sup>2</sup> quality.
- The support and availability of the listed specifications and functionalities varies depending on operating systems, applications and network protocols as well as network and system configurations.
- The stated life expectancy of each consumable is based on specific operating conditions such as page coverage for a particular page size (6% coverage of A4). The actual life of each consumable will vary depending on use and other printing variables including page coverage, page size, media type, continuous or intermittent printing, ambient temperature and humidity.
- Some product illustrations contain optional accessories.
- Specifications and accessories are based on the information available at the time of printing and are subject to change without notice.
- Konica Minolta does not warrant that any specifications mentioned will be error-free.
- All brand and product names may be registered trademarks or trademarks of their respective holders and are hereby acknowledged.



For complete information on Konica Minolta products and solutions, please visit: [www.konicaminolta.ca](http://www.konicaminolta.ca)

© 2021 KONICA MINOLTA BUSINESS SOLUTIONS (CANADA) LTD. All rights reserved. Reproduction in whole or in part without written permission is prohibited. KONICA MINOLTA and the KONICA MINOLTA logo are registered trademarks or trademarks of KONICA MINOLTA, INC. All other product and brand names are trademarks or registered trademarks of their respective companies or organizations. All features and functions described here may not be available on some products. Design and specifications are subject to change without notice.



KONICA MINOLTA

KONICA MINOLTA BUSINESS SOLUTIONS (CANADA) LTD.  
5875 Explorer Drive, Suite 100, Mississauga, Ontario L4W 0E1

[www.konicaminolta.ca](http://www.konicaminolta.ca)



Item #: 4750iSS  
3/2021-A